

PLANTA BAIXA - PAVTO TÉRREO

A TOTAL = 881,71m²
 A COMP = 96,96m²
 A NÃO COMP = 784,75m²

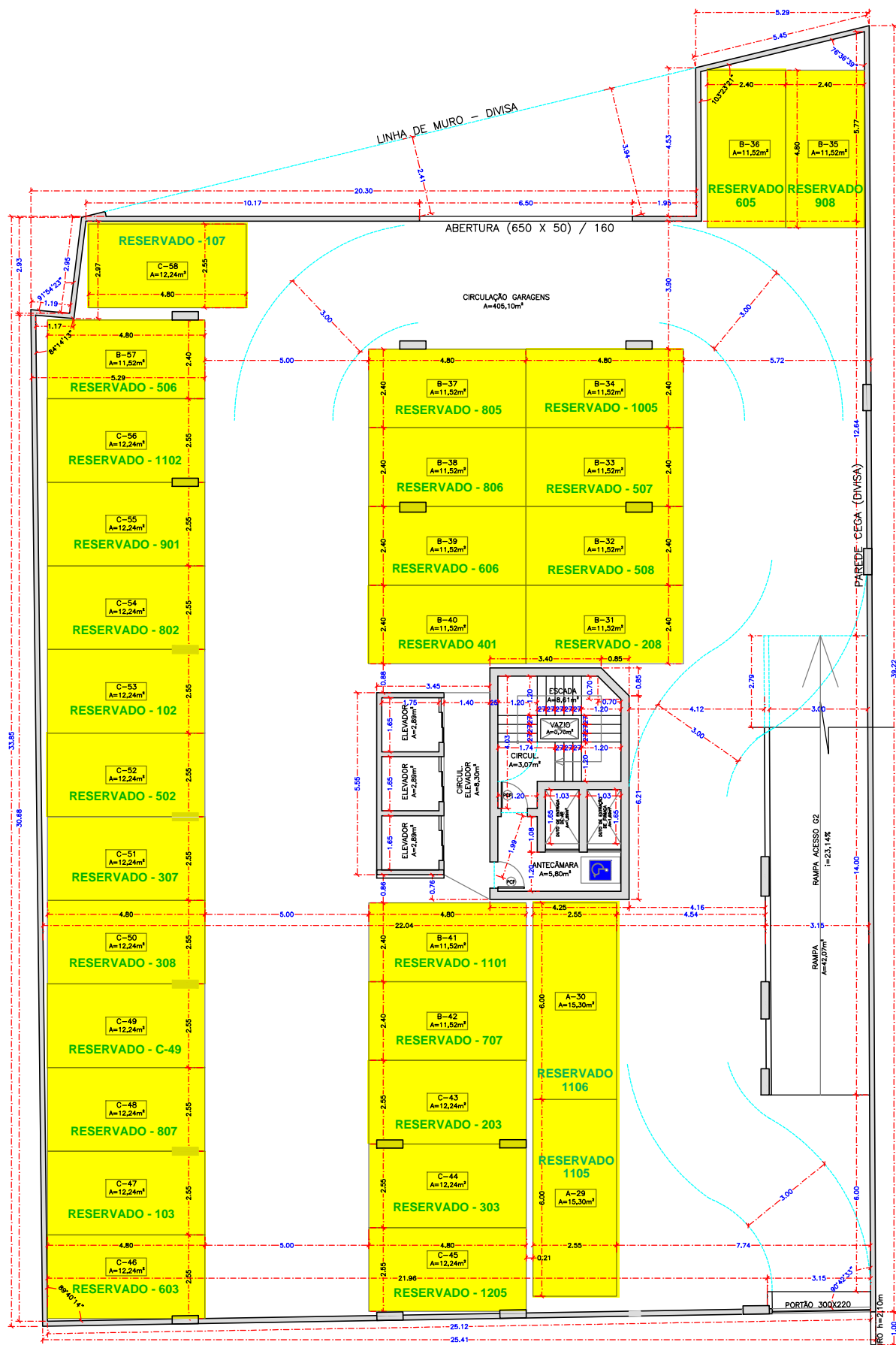

PLANTA BAIXA - PAVTO G1
 A TOTAL = 881,71m²
 A COMP = 36,57m²
 A NÃO COMP = 845,14m²

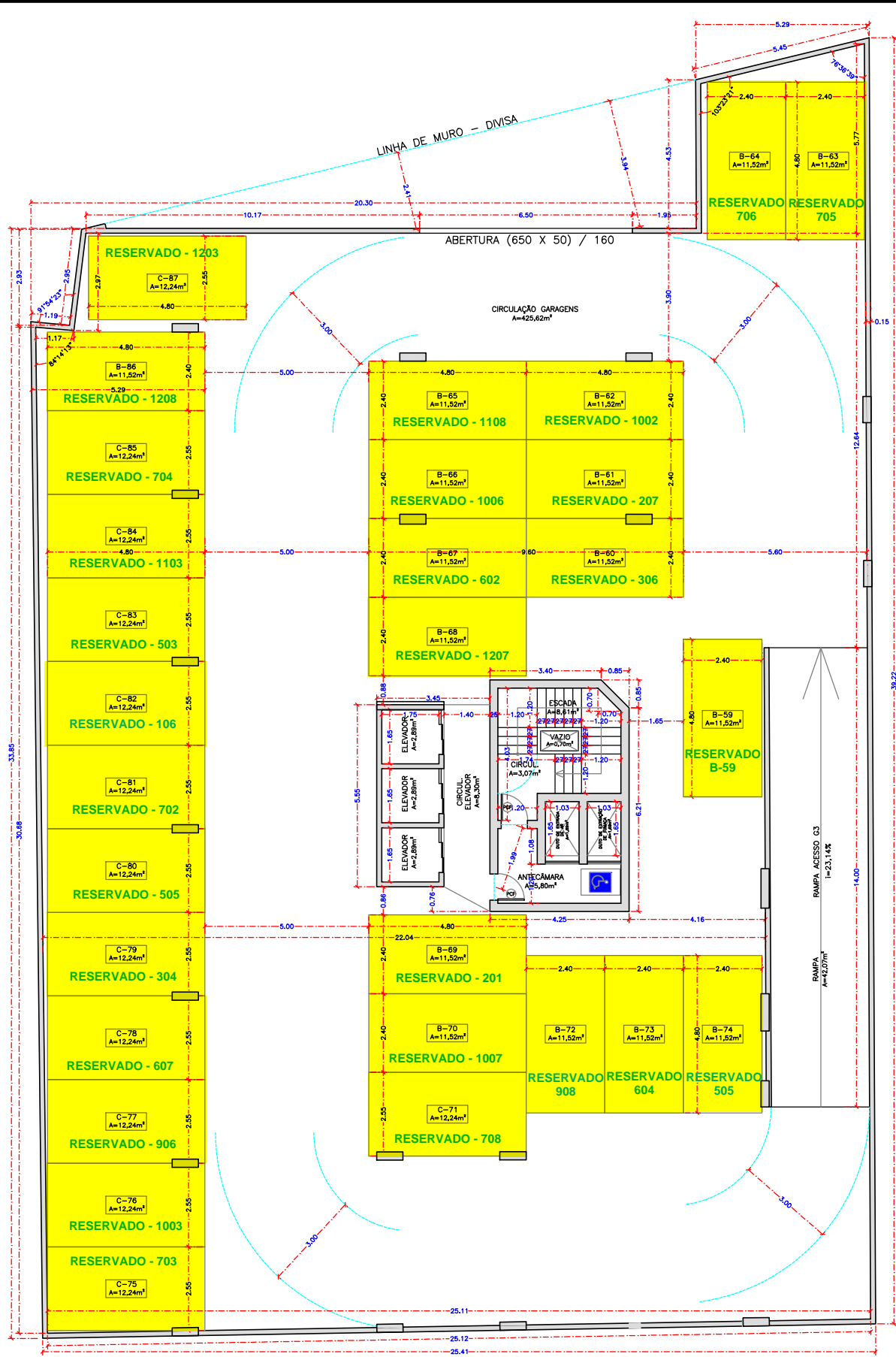

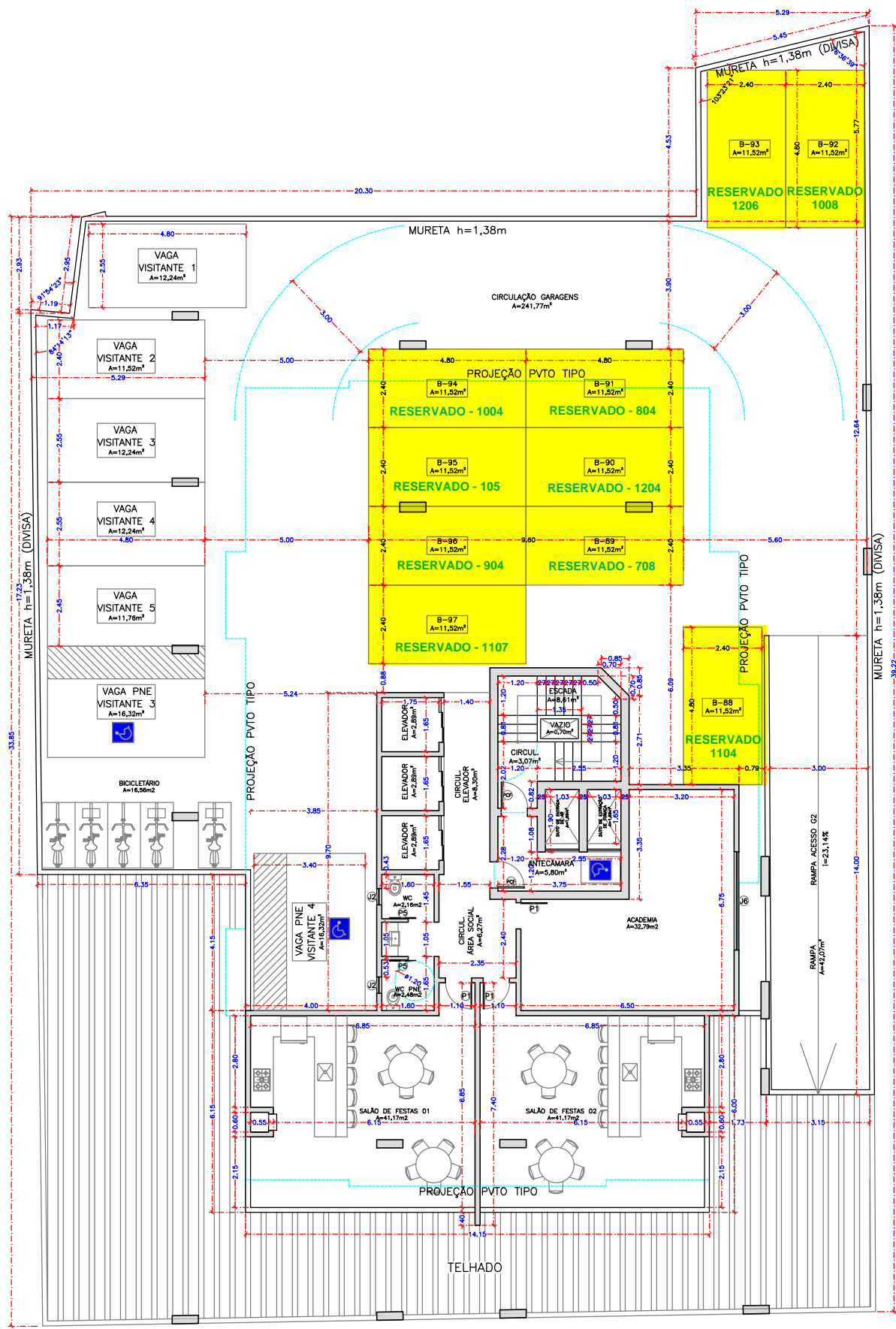

PLANTA BAIXA - PAVTO G3
 A TOTAL = 712,04m²
 A COMP = 175,04m²
 A NÃO COMP = 537,00m²